



---

65 Wargrave Road,  
Twyford, RG10 9PD  
**Price guide £1,650,000**

---



[wentworthea.com](http://wentworthea.com)

---

# Wargrave Road

---

This stunning detached five bedroom family house is on the desirable Wargrave Road, this exquisite house offers a perfect blend of modern living and spacious comfort. With five generously sized bedrooms, including two with ensuite bathrooms, this property is ideal for families seeking both privacy and convenience.

The heart of the home is a stunning kitchen, dining, and living space that has been thoughtfully renovated by the current owners. This impressive area features a large island, making it perfect for entertaining guests or enjoying family meals. The three reception rooms provide ample space for relaxation and social gatherings, ensuring that there is room for everyone to unwind.

Outside, the property boasts a large garden, complete with outbuildings that offer additional storage or potential for creative use. The detached double garage adds to the convenience, while the expansive driveway provides parking for up to eight vehicles, a rare find in today's market.

This home is not just a place to live; it is a sanctuary that combines style, space, and functionality. The house is within walking distance to Twyford railway station and the village centre with shops, pharmacy, pubs, coffee shops, Tesco Express and Waitrose.

With its prime location and exceptional features, this property is a must-see for anyone looking to settle in a vibrant community.

Don't miss the opportunity to make this stunning house your new home.



#### Entrance Hall

A lovely, open entrance hall providing access to the reception rooms and stairs leading to the first floor.

#### Cloakroom

Fully tiled and fitted with a WC, a wash hand basin with storage beneath, and a towel rail.

#### Study

Tucked away off the entrance hall, this is a fantastic addition, providing a second office space with a window allowing for plenty of natural light.

#### Office / Reception room

Located off the entrance hall, a generously sized office offering ample space for two desks, with a large window allowing plenty of natural light to flood the room.

#### Kitchen / Dining room

A stunning room positioned at the rear of the house, filled with natural light from the patio doors and large windows overlooking the garden. The kitchen offers a range of eye and base level units, along with a generous island providing seating space for four stools. There is ample room for a sofa to enjoy the beautiful garden outlook, as well as a large eight-seater dining table. The kitchen benefits from an integrated dishwasher, a large range cooker, and space for a fridge/freezer. Underfloor heating adds further comfort to this impressive living space.

#### Utility room

Located off the kitchen, the utility room offers space for a washing machine and tumble dryer within the fitted units, along with an additional sink and plenty of further storage. The room also benefits from a side access door.

#### Living room

A spacious 23ft<sup>2</sup> reception room featuring a log burner, perfect for enjoying the colder evenings. The room benefits from dual access from both the entrance hall and kitchen, along with patio doors opening out to the garden.

#### Master Bedroom and ensuite

Situated at the rear of the property, this impressive bedroom benefits from a Juliet balcony overlooking the garden and an abundance of natural light. The spacious, fully tiled en-suite comprises a shower, bath, WC, and a wash hand basin with storage beneath.

#### Bedroom 2 and ensuite

Situated at the rear of the property, a well-proportioned double bedroom benefiting from an en-suite comprising a shower, WC, and wash hand basin.

#### Bedroom 3

At the front of the property, a further double bedroom featuring fitted wardrobes.

#### Bedroom 4

Situated at the front of the property, a well-proportioned double bedroom.

#### Bedroom 5

At the rear of the property, the smallest room, but also fits a small double bed.

#### Family Bathroom

Fully tiled and fitted with a corner shower, bath, WC, and a large wash hand basin with storage beneath.

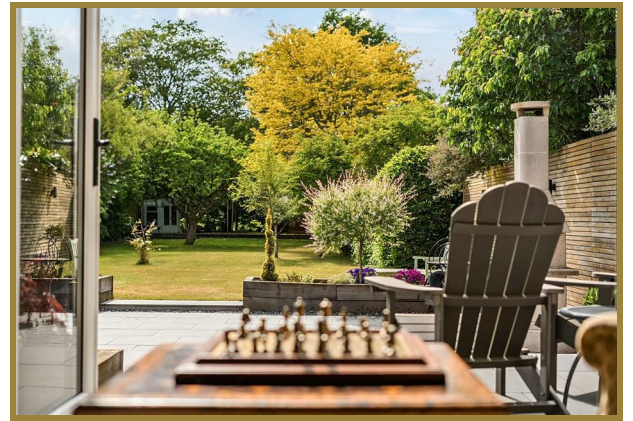

The Old Butchers, 15 High Street, Twyford, Berkshire, RG10 9AB  
t: 0118 934 0027 e: twyford@wentworthea.com

wentworthea.com



wentworth\_ea



wentworthestateagents



## Wargrave Road, Twyford, Reading, RG10



Approximate Area = 2314 sq ft / 214.9 sq m

Garage = 281 sq ft / 26.1 sq m

Outbuilding = 164 sq ft / 15.2 sq m

Total = 2759 sq ft / 256.2 sq m

For identification only - Not to scale

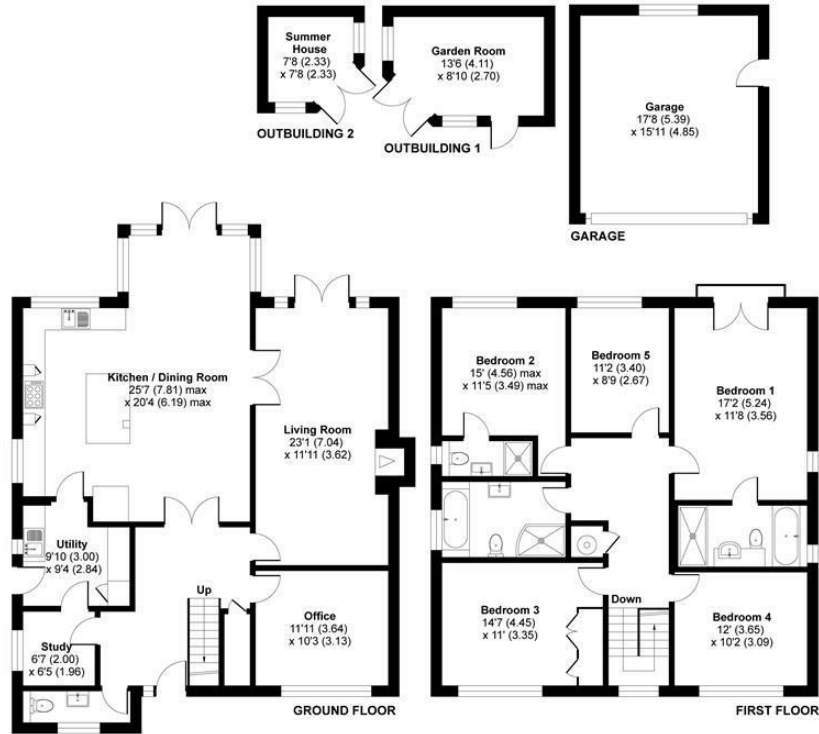

# The Estate Agent People Recommend



**IMPORTANT:** we would like to inform prospective purchasers that these sales particulars have been prepared as a general guide only. A detailed survey has not been carried out, nor the services, appliances and fittings tested. Room sizes should not be relied upon for furnishing purposes and are approximate. If floor plans are included, they are for guidance only and illustration purposes only and may not be to scale. If there are any important matters likely to affect your decision to buy, please contact us before viewing the property.